



**Heradesign®**

CREATIVE

Product data

Heradesign® Creative modul



# PRODUCT PROGRAMME

## Module 300/600

Triangle 300/600

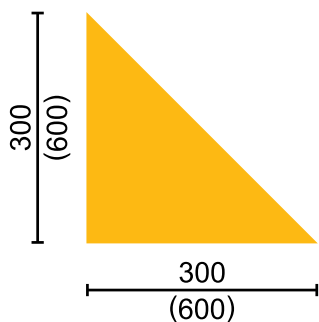

Parallelogram-L 300/600

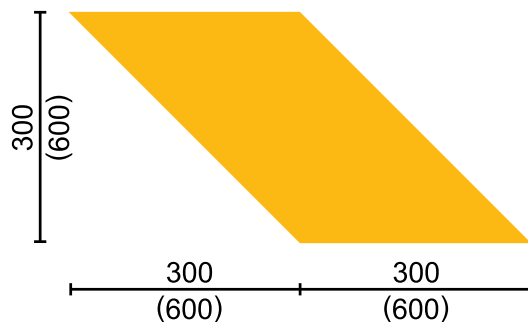

Square 300/600

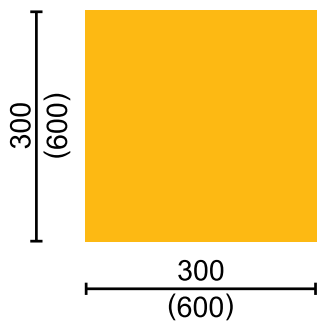

Parallelogram-R 300/600

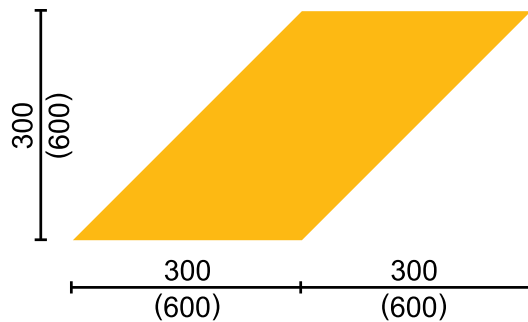

Hexagon 300/600

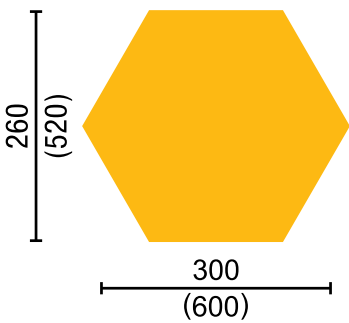

Rectangle 300/600

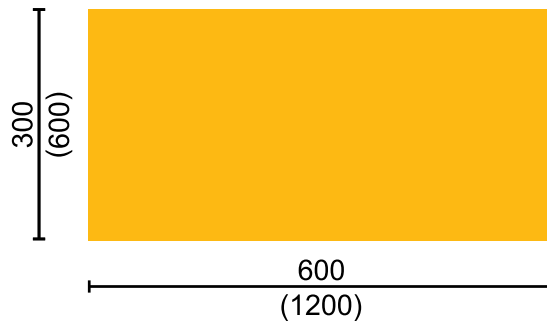

Circle 300/600

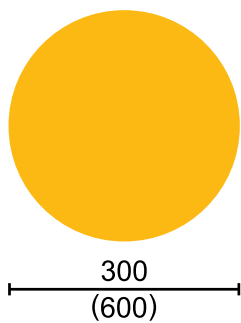

Strip 300/600

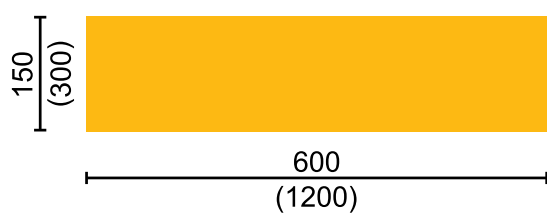

This product information corresponds to the present state of development of our products and become invalid on the publication of a new version. Always make sure that you use the latest version of this information. The suitability of the product is not binding for special individual cases. Warranties and liability for deliveries are governed by our General Terms of Business. Only defect-free products may be installed. No liability will be accepted for the assembly of defective products or for the resulting costs (delay in delivery, remediation of defects). All data are included without warranty. Version 01/2021 - JB

# SURFACES AND EDGES

## HERADESIGN® *fine*



1-layer magnesite bonded wood wool acoustic tile (fibre width 2 mm). Characteristic surface texture, building biology recommended.

## HERADESIGN® *superfine*



1-layer magnesite bonded wood wool acoustic tile (fibre width 1 mm). Fine surface texture, building biology recommended.

## HERADESIGN® *micro*



1-layer magnesite bonded wood wool acoustic tile with a fine pore surface texture, building biology recommended.

## Application areas

As decorative and acoustically effective wall claddings for use in interior areas.

## Edge configuration AK-01

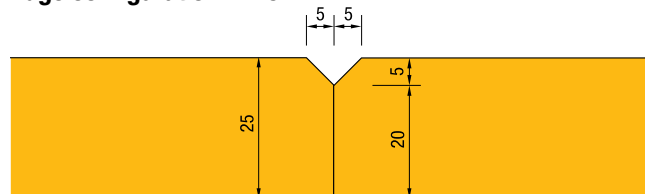

## Colours

The natural surface texture of the wood wool panels is perfect for creative design and colouring. An almost unlimited range of colours is available – you can choose almost any colour from popular colour systems such as RAL, NCS or StoColor.

Standard colours	Pastel colours	Full tone colours
●	●	●

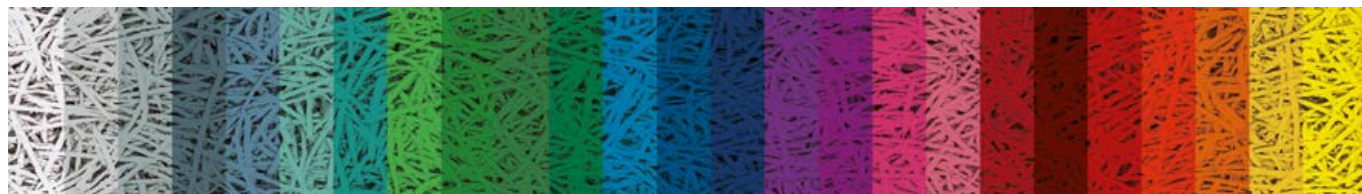

# TECHNICAL DATA

Requirement per m <sup>2</sup> of wall or ceiling area							
Description		Module 300 <sup>1)</sup>			Module 600 <sup>2)</sup>		
		Area [m <sup>2</sup> ]	Pcs./m <sup>2</sup>	Pcs./carton	Area [m <sup>2</sup> ]	Pcs./m <sup>2</sup>	Pcs./carton
	Triangle	0.045	22.22	28	0.180	5.56	40
	Parallelogram	0,090	11,11	7	0,360	2,78	10
	Square	0,090	11,11	14	0,360	2,78	20
	Rectangle	0.180	5.56	7	0.720	1.39	10
	Strip	0.090	11.11	14	0.360	2.78	20
	Circle	0.070	11.11	14	0.283	2.78	20
	Hexagon	0.058	17.25	14	0.234	4.27	20

<sup>1)</sup> Element 300: max. 20 cartons per palette

<sup>2)</sup> Element 600: max. 3 cartons per palette

# INSTALLATION

## Notes on installation guidelines

HERADESIGN® *creative* modules are produced, checked and transported to the construction site with great care.

When receiving the material, please always check:

- Number of package units (palettes, cartons, m<sup>2</sup>)
- Compare the contents of the package units with the delivery note and the labels on the packaging
- Accessories: plugs, screws, re-touch paint, profiles or other items
- Are the goods or parts damaged?

**IMPORTANT:** If there are any transport damages, insufficient quantities, or other discrepancies have this certified by the driver. Also, immediately inform the dealer that shipped the goods.

Important factors for a successful and attractive HERADESIGN® *creative* installation are exact processing and suitable working conditions. Only careful work and high product quality ensure a satisfactory result.

The installation of HERADESIGN® *creative* tiles is part of interior decorating and must only be carried out under controlled humidity and temperature conditions. All dust-causing construction measures must be completed before starting the installation.

Check the HERADESIGN® *creative* modules for damage before installation. Damaged tiles should not be installed.

Transport to site, unpacking the HERADESIGN® *creative* products and handling should always be carried out with due care. Always work with clean hands and clean tools. We recommend wearing clean gloves.

Before starting installation, check the underlying surface for loadbearing capacity.

When required, the modules can be cut using a circular saw, table saw or jigsaw. Remove any dust with a soft brush.

Slight damage to the tile surface as well as cut edges are carefully painted after installation. This is done with a fine brush. Only apply a small amount of paint to avoid colour differences. Cut edges or later produced fibres can be painted with a short-haired roller (e.g. microfibre roller 13 mm, paint roller 10 mm, etc.) or brush.

When using the HERADESIGN® *creative* modules with screw installation, we recommend HERADESIGN® Bitholder “easy” for exact installation of the screws. The required screw depth must be set on a sample tile before installation.

## Variant of screw installation on the wall and on the ceiling.

Alternatively, HERADESIGN® *creative* acoustic elements can be screw fixed onto 60 x 27 x 0.6 mm CD profiles or 30 / 60 mm wooden lathes. Screw type: HERADESIGN® screws, 50 x 4.5 mm.

Alternatively, grooved or resin-treated staples may be used. Staple width >8 mm, staple length >50 mm.

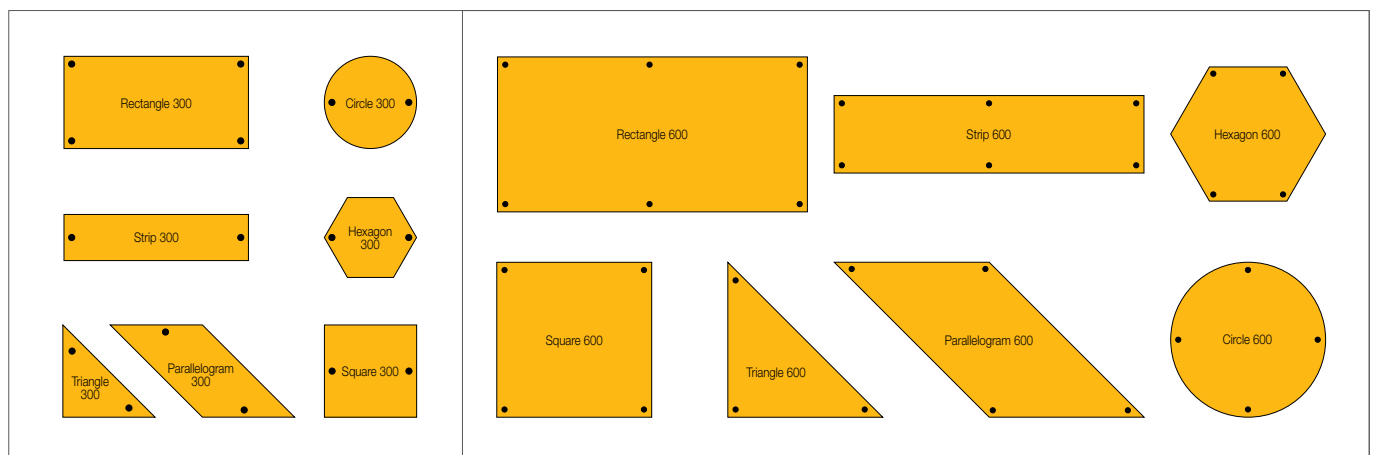

The location of the screws can vary depending on the pattern and substructure when using 300 mm elements.



## Variant: Adhesive installation on the wall

The following installation guidelines refer to the adhesive installation of HERADESIGN® *creative* acoustic elements in 300 mm modules on the wall up to a maximum wall height of 3 m. For installation with HERADESIGN® screws, follow the corresponding procedure.

**IMPORTANT:** The underlying surface must be able to take the load, level, dry and dust-free. Handling and underlying surface temperature min. +7°C. Surfaces with unknown properties should be checked for their adhesion.

The general guidelines for the installation of HERADESIGN® wood wool acoustic tiles must be observed.

**1 | MARK**  
a horizontal guide.

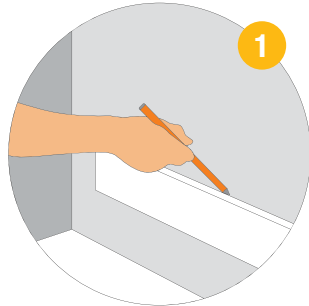

**2 | MARK**  
a vertical guide.

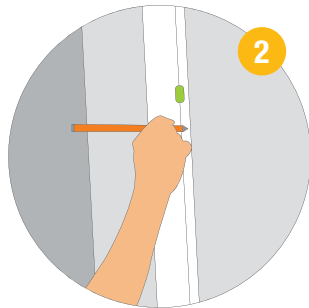

**3 | DEFINE THE MODULE**  
Depending on the type of module to be adhered, several guides in a 300 mm or 600 mm module may be necessary.

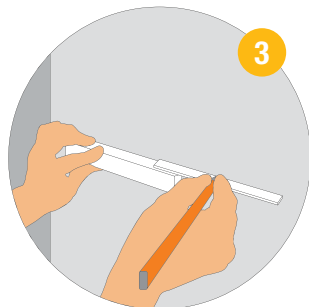

**4 | APPLY ADHESIVE**  
Apply a line of adhesive to the acoustic element. Knauf AMF recommends using Knauf POWER-ELAST.

Processing time: approx. 15 min  
Amount: approx. 1 cartridge/m²

Illustrative example of the adhesive application lines.

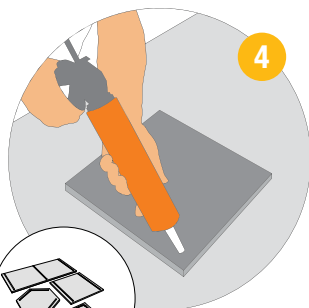

**5 | ALIGN**  
the elements to the module and adhere to the underlying surface by applying pressure.



**6 | INSTALL THE FIRST ROW**

The first row must be installed with high accuracy. To ensure the elements don't slip and to ease alignment we recommend using a horizontal stop bar. Alternatively, the first row can be secured with screws or wall tacks.

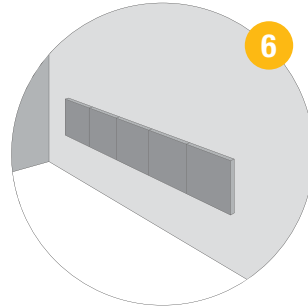

**7 | FURTHER ADHESIVE**

The next rows from the bottom are positioned and adhered. The position of the elements should be checked at regular intervals with a spirit level.

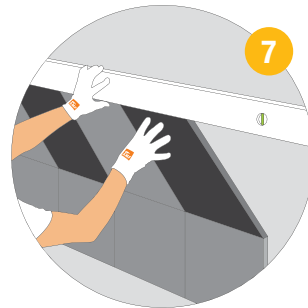

**8 | CHECK**

After completion, any colour damage or fibre breakage may be improved with a small brush and the supplied repair paint.

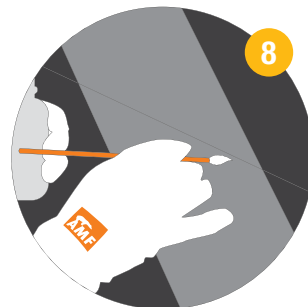

**9 | ENJOY**

Completed wall installation

